



Ministério  
das Finanças  
Unidade de Gestão  
de Projectos Especiais



TECHPARK  
CABO VERDE

# UNIDADE DE GESTÃO DE PROJECTOS ESPECIAIS

## CABO VERDE TECHNOLOGY PARK – PHASE II

Av. Amílcar Cabral, ex-Edifício BCV, 4º Andar  
Plateau - Cidade da Praia, Ilha de Santiago  
C.P. nº 145, República de Cabo Verde  
Tel: + 238 - 261 7584/261-6198  
[www.governo.cv](http://www.governo.cv)

### TECHPARK CV ART COMPETITION

No. 020/CVTP-II/UGPE/2024

#### DOCUMENTS TECHPARK CV ART COMPETITION (EDITAL)

Cabo Verde Technology Park (CVTP) – Phase II

**Project:** Cabo Verde Technology Park (CVTP) – Phase II  
**Purchaser:** Unidade de Gestão de Projectos Especiais (UGPE) | Ministério das Finanças  
**Country:** Republic of Cabo Verde  
**Issued on:** May 29, 2025

**Amendment # 1:** July 01, 2025

## CONTEÚDO

1. BACKGROUND .....	3
2. OBJECTIVES .....	4
3. EVALUATION CRITERIA & AWARD.....	4
Receival of proposals:.....	4
Joint Proposals and Contracting Arrangement .....	5
Evaluation Criteria:.....	5
Evaluation Committee: .....	7
Award: .....	7
4. OPEN DAY & CLARIFICATIONS .....	7
5. RESPONSABILITIES:.....	8
6. LIST OF WALL SURFACES FOR MURAL INSTALLATION:.....	8
7. MURAL INSTALLATION GOALS: .....	9

# TECHPARK CV ART COMPETITION

No. 020/CVTP-II/UGPE/2024

UGPE (Unidade de Gestão de Projectos Especiais), hereby invites artists in to submit a proposal for mural installations at TECHPARK CV. Proposals will be due no later than **August 18, 2025**.

## 1. BACKGROUND

The Government of Cabo Verde has received a loan of \$14 million from the African Development Bank (hereafter named “the Bank”) to implement the Cabo Verde Technology Park Project – Phase II. This ambitious project aims to transform the Republic of Cabo Verde into a digital and innovation hub by operationalizing a state-of-the-art technology park. This park will be equipped with modern infrastructure and workspaces, creating an innovative ambience that will house a range of companies, from emerging start-ups to established multinational technology firms.

The Cabo Verde Technology Park Project consists of several key components designed to foster digital transformation and economic development:

**Component A** – Operationalization of the Climate Resilient Technology Park Infrastructure

**Component B** – Business Development and Capacity Building

**Component C** – Project Management and Institutional Strengthening

Central to the park’s identity, art will be strategically integrated both indoors and outdoors, through the installation of murals and sculptures. This artistic infusion will not only enhance the visual appeal of the park but will also reflect the cultural essence of Cabo Verde, making the park a landmark of innovation and creativity from the inside out.

## 2. OBJECTIVES

The objective of integrating art into the Cabo Verde Technology Park is to create an innovative and inspiring environment that fosters creativity, collaboration, and cultural expression. By embedding art within the park's infrastructure we aim to:

**Enhance the Aesthetic Appeal:** Transform the park into a visually stimulating space that reflects the cultural richness of Cabo Verde while promoting a forward-thinking and dynamic atmosphere.

**Promote Cultural Identity and Innovation:** Celebrate local and regional art forms, blending traditional and contemporary styles to create a unique identity for the park that resonates with its technological and innovative focus.

**Foster Community Engagement:** Encourage interaction between the tech community, local artists, and the broader public through collaborative art projects, exhibitions, and workshops, thereby creating a vibrant community hub.

**Inspire Creativity and Innovation:** Leverage the power of art to inspire creativity among park residents, visitors, and stakeholders, contributing to an environment conducive to innovative thinking and problem-solving.

**Support Artistic Development:** Provide a platform for artists, especially emerging talent, to showcase their work and explore the intersection of art, technology, and innovation, contributing to their professional growth.

## 3. EVALUATION CRITERIA & AWARD

To implement this activity, the Project will issue an Art Challenge Competition inviting both national and international artists.

### Receival of proposals:

Proposals must be delivered, by e-mail indicating below, until **August 18, 2025**:

E-mail: [debora.vieira@mf.gov.cv](mailto:debora.vieira@mf.gov.cv); [edna.fernandes@mf.gov.cv](mailto:edna.fernandes@mf.gov.cv); [karine.tavares@mf.gov.cv](mailto:karine.tavares@mf.gov.cv); [adilma.silva@mf.gov.cv](mailto:adilma.silva@mf.gov.cv)

C/c: [nuno.gomes@mf.gov.cv](mailto:nuno.gomes@mf.gov.cv); [carlos.delgado@techpark.cv](mailto:carlos.delgado@techpark.cv)

### **Joint Proposals and Contracting Arrangement**

Submission of proposals is allowed either **individually** or **jointly** (pairs, groups, or artistic collectives). In such cases, the following provisions apply:

#### **1. Identification of Participants:**

All jointly submitted proposals must:

- Identify all participating artists;
- Designate a **primary representative** (hereinafter referred to as the "lead artist") who will be responsible for communication with the organizing entity and for signing the contract.

#### **2. Contracting Arrangement:**

If a joint proposal is selected:

- The contract will be signed exclusively with the lead artist, who will assume full responsibility for the execution of the proposal and internal team management.

The contracting modality will be defined in coordination with the organizing entity, based on the structure of the selected proposal.

### **Evaluation Criteria:**

Proposals will be evaluated based on the following evaluation criteria:

- 1. Artist background**
- 2. Selected Location**
- 3. Proposed installation**
- 4. Cost estimate**
- 5. Dimension**
- 6. Implementation timeline**

**In the case of joint proposal submissions, the experience and portfolio of the artists will be evaluated collectively.**

Proposals should include and will be evaluated by the following:

- **Artist background:** should briefly highlight the artist's biography, style, relevant experience, and connection to the project, emphasizing past large-scale public works and cultural ties
- **Selected Location:** specify the chosen location for each installation within the list of wall surfaces, mural installations and sculptures provided in the page 4 of this document. Consider how the location influences visibility, interaction, and thematic relevance.
- **Proposed installation:** include a detailed description of the concept, materials, and intended impact of the artwork, explaining how it aligns with the project's goals and cultural context. Additionally, the proposal must be accompanied by a visual representation of the installation, such as a hand-drawn or digital drawing, 3D rendering, or photographs of a physical model.
- **Cost estimate:** Provide an itemized breakdown of all major components, including materials, labor, transportation, and installation, with specific costs for each. The estimate should consider any potential extra costs, such as maintenance, insurance, or site preparation.

The maximum amount available for all pieces is 163.000 EUR, one artist can apply to as many available location as they want, but the maximum award amount per artist cannot exceed 30.000 EUR.

**The maximum award amount per approved proposal remains unchanged (€30,000), regardless of the number of participants.**

Overpricing or budget inflation will result in elimination.

- **Dimension:** Provide the exact measurements (height, width, depth) for each mural or sculpture to give a clear sense of the scale. Mention any site-specific preparations (e.g., structural adjustments, foundation work) required for the installation.
- **Implementation timeline:** provide a detailed timeline from start to finish, including key milestones such as design approval, material sourcing, site preparation, installation, and final inspection. Ensure the timeline accounts for potential delays due to weather,

transportation, or material availability. Specify the expected completion date to keep the project on schedule and ensure accountability.

### **Evaluation Committee:**

The Evaluation Committee is composed of representatives from Techpark CV, the Project Architect, UGPE, the African Development Bank (AfDB) and two independent consultants experienced in the field will review the proposals and select several artists to create mural and sculpture installations at TECHPARK CV. The design details of each installation will be coordinated with nearby interior design elements, with final approval granted before execution.

### **Award:**

The winning participants will have an agreement with the TechPark CV Project phase 2 to implement their art at TechPark CV, receive recognition certification from the TechPark CV and AfDB as a contributor of the implementation of TechPark CV and be published on national channels to guarantee transparency. All the other participants will receive a participation certificate.

## **4. OPEN DAY & CLARIFICATIONS**

**Open Day:** As part of the competition process, we invite all interested participants to attend our Open Days, where you can explore the designated locations for the murals and art installations at Cabo Verde Technology Park. There will be both virtual and physical events to accommodate all attendees.

**Date:** July 29, 2025

**Time:** 10:00 (CVTIME)

**Location:** Cabo Verde Technology Park, Achada Grande Trás, Praia, Cabo Verde

**Platforms:** Instagram Live and Facebook Live

We will host on-site tours of the selected locations for the installations. This will be a great opportunity to view the space firsthand, discuss any project-related queries, and connect with the project team. The tour will offer valuable insights into how the artwork will interact with the physical environment.



For those unable to attend in person we will have virtual tours on Instagram and Facebook Live, where we will showcase the spaces allocated for the murals and sculptures. The virtual tour will include a guided walkthrough of the installation sites, providing you with key insights into the project and space. Participants will also have the opportunity to ask questions via the live chat. We encourage all participants to attend either virtually or physically to gain a comprehensive understanding of the spaces.

**Clarifications:** Any requests for clarifications should be submitted to:

E-mail: [debora.vieira@mf.gov.cv](mailto:debora.vieira@mf.gov.cv); [edna.fernandes@mf.gov.cv](mailto:edna.fernandes@mf.gov.cv); [karine.tavares@mf.gov.cv](mailto:karine.tavares@mf.gov.cv); [adilma.silva@mf.gov.cv](mailto:adilma.silva@mf.gov.cv)

C/c: [nuno.gomes@mf.gov.cv](mailto:nuno.gomes@mf.gov.cv); [carlos.delgado@techpark.cv](mailto:carlos.delgado@techpark.cv)

## 5. RESPONSABILITIES:

Artists will be responsible for designing, producing, and installing their original work on predetermined vertical wall surfaces throughout the innovation campus. Detailed descriptions and dimensions of these wall surfaces are provided in this document.

## 6. LIST OF WALL SURFACES FOR MURAL INSTALLATION:

No.	Building	Mural
1	INCUBATION CENTER	IC EM 01 - Exterior Mural
2		IC EM 02 - Exterior Mural
2		IC EM 03 - Exterior Mural
3		IC EM 04 - Exterior Mural
3		IC IM 01 - Interior Mural
4		IC IM 02 - Interior Mural
4		IC IM 03 - Interior Mural
5		IC IM 04 - Interior Mural
5		IC IAI 01 - Interior Art Installation
6		IC SC 01 - Sculpture



6	<b>BUSINESS CENTER</b>	BC EM 01 - Exterior Mural
7		BC IM 01 - Interior Mural
7		BC IM 02 - Interior Mural
8		BC SC 01 - Sculpture
8	<b>TRAINING CENTER</b>	TC EM 01 - Exterior Mural
9		TC SC 01 - Sculpture
9	<b>CONFERENCE CENTER</b>	CC EI 01 - Exterior Installation
10		CC IM 01 - Interior Murals
11		CC IM 02 - Interior Murals
12		CC SC 01 - Sculpture
13	<b>SKATE PARK</b>	SP EM 01 - Exterior Mural

## 7. MURAL INSTALLATION GOALS:

TechPark CV aims to harness Cabo Verde's unique location in the heart of the Atlantic to become a vibrant crossroads of cultures, knowledge, and innovation. We envision a dynamic and welcoming environment, fully equipped with the infrastructure needed to inspire people from around the world to consider working here—whether for months, years, or even relocating their businesses to Cabo Verde.

At TechPark CV, we're redefining the working culture by offering diverse workspaces that cater to different needs, from serene quiet zones to lively, collaborative areas. Our park integrates interior and exterior spaces, encouraging a healthy lifestyle with dedicated areas for exercise and relaxation. We want every space within the park to resonate with Cabo Verdean and African culture, providing a deep, immersive experience for all who visit.

TechPark CV is a celebration of Pan-Africanism and Afrofuturism, affirming Africa as a hub of innovation and creative energy. We want people to choose TechPark CV as their working destination during winter, enjoying the beautiful weather of Cabo Verde, or to see it as a stable and inspiring location to base their business during times of uncertainty in their home countries.

As visitors land in Praia or drive through the park, we want them to feel the vibrant energy and be drawn in by the curiosity to explore what we have created. TechPark CV is not just a place to work—it's a place where innovation thrives, culture is celebrated, and the future is built.

### Incubation Center

This is where **ideas come to life**—the most **vibrant and energetic** building in the park, **designed to foster creativity, connection, and collaboration**. It features the highest concentration of

communal spaces, each carefully crafted to accommodate diverse working styles. Whether you need a lively atmosphere or a quiet corner, a space for playful interaction or focused work, a place to exercise or simply relax—you'll find it all here, perfectly balanced to support your unique needs.

### Exterior Wall Surfaces for Mural Installations

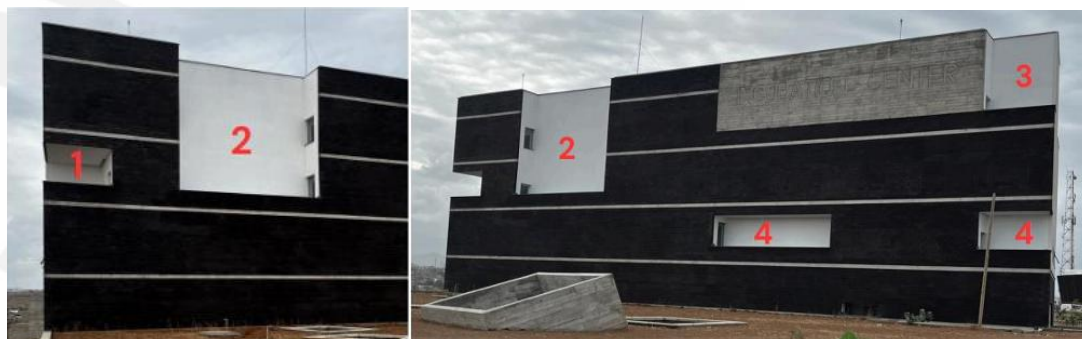

#### IC EM 01 - Exterior Mural

Size: Width 4,73m | Height 2,20

#### IC EM 02 - Exterior Mural

Size: Width 10,42m | Height 8,59m

#### IC EM 03 - Exterior Mural

Size: Width 4,10m | Height 4,47m

#### IC EM 04 - Exterior Mural

4.1 Size: Width 8,95 m | Height 2,20m

4.2 Size: Width 4,10 m | Height 2,20m

### Interior Wall Surfaces for Mural Installations

#### IC IM 01 - Interior Mural

This dynamic space is **designed to ignite creativity and foster connection, drawing inspiration from the vibrancy of African marketplaces. Here, cultures blend, ideas flow, and people come together at a crossroads of innovation.** The space serves as a hub for collaboration, rooted in African heritage while embracing **Afrofuturism and Pan-Africanism.**

The vibrant mural, featuring the phrase "come to life," spans the wall, telling a visual story of unity through simple figures from West Africa. Green accents on the ceiling and floor symbolize life and growth, while varied seating options—from dark green sofa—enhance both comfort and creativity.

Natural elements, like a woven floor lamp and wooden stool with woven top further enrich the inviting atmosphere, making this a space where ideas flourish and connections are made.

The **space blends tradition and innovation, fostering creativity and collaboration.** With its vibrant design, flexible seating, and natural touches, it **invites people to gather, share ideas, and be inspired by the crossroads of culture and innovation.**

**Size: Width 7,11m | Height 2,40**

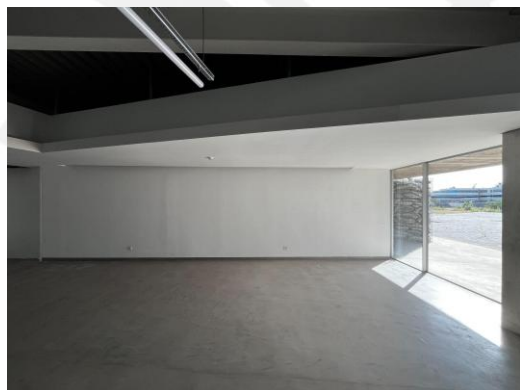

### **IC IM 02 - Interior Mural**

Game Room I is an exciting and energetic space **designed to foster active engagement and community interaction.**

The room's central design is defined by a mural inspired by arcade games, blending futuristic elements such as tech languages, codes, and iconic symbols like Pac-Man.

**Note that this Art Installation has to be easily removable from the concrete wall**

**Size: Width 7,11m | Height 2,40m**

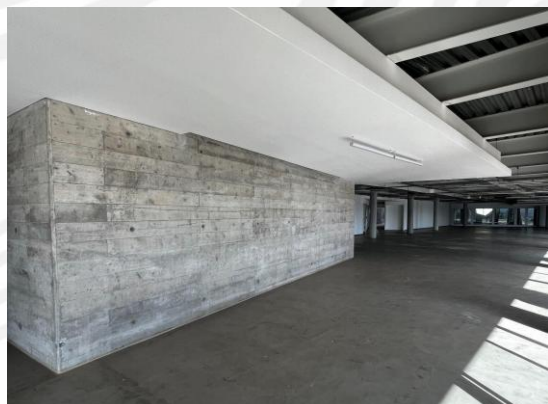

### **IC IM 03 - Interior Mural**

This dynamic yet minimal space symbolizes Cabo Verde as a launchpad for future innovations, connecting Africa to the world.

This presentation area is a flexible, visually dynamic space designed to encourage collaboration and innovation.

**Size: Width 10,00 m | Height 9,77**



### **IC IM 04 - Interior Mural**

On entry into the reception, you're welcomed by a colorful U-shaped mural painted on the entire walls, labeled A, B and C of the lounge seating area with the TECH PARK CV logo placed at the center of the plain extension of wall A in clear acrylic with light.

The Incubation Hub can be referred to as a community center where people from different backgrounds and organizations with different interests and areas of specialization meet.

It acts as a symbol of unity and Pan-Africanism with the end goal of all interactions being growth and the birth of new ideas. The mural is inspired by the significance of the family unit in birthing great individuals. A family is a breeding ground just like an incubation hub.

**04.A Size: Width 5,90 m | Height 2,40 m**

**04.B Size: Width 5,38 m | Height 2,40 m**

**04.C Size: Width 2,39 m | Height 2,40 m**

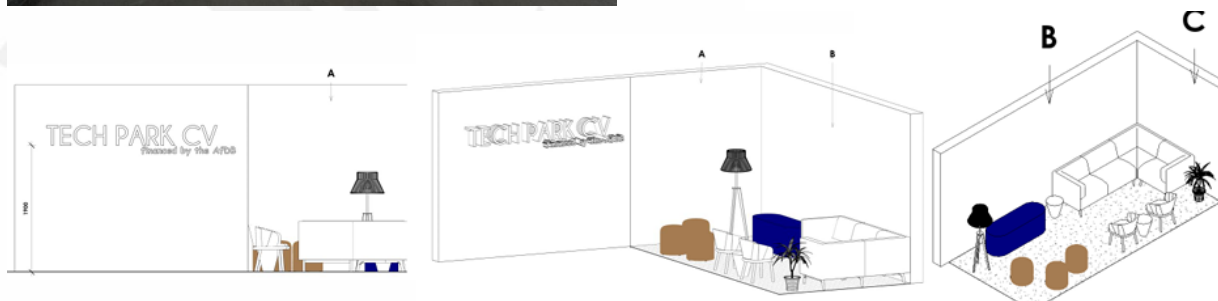

Elevation Views of Reception lounge showing seating arrangement and location of the "TECH PARK CV"

### **IC IAI 05 - Interior Art Installation**

The hanging art piece for the multi-leveled atrium area aims to create a connection between the 4 floors: from the 3rd floor to the basement.

Major Considerations:

- 1. Structural Consideration:** the narrow area where the art would be hung.
- 2. Sustainability** in terms of design, i.e. using local craft materials and reflecting the story telling of the people.
- 3. Collaboration:** The idea of the incubation center is to bring people together with a single goal, growth.

The aesthetic value and impact made during the journey would also not be ignored. The art pieces are layered in a descending order, with the highest points on the top floor and flowing down to the basement level.



**Size: Width 10,00 m | Height 9,77**

## Sculptures

### IC SC 01 - Sculpture

This sculpture is located in the Canteen Patio, it should be an installation that creates a fun seating area in the exterior of the Incubation Center, where people can enjoy the great weather of Cabo Verde to work outside.





## Business Center

The Business Center, in contrast to the Incubation Center, exudes a more **corporate atmosphere**—**marked by professionalism, elegance, and tranquility**. Common spaces are more selective but provide a **comfortable retreat** from the bustle of traditional work environments, ideal for **informal meetings or quick conversations**. **Art pieces are also showcased here**, offering an opportunity for users or visitors to purchase unique works.

Coworking spaces in the Business Center are designed for those who seek a high-quality, **serene environment to focus and work efficiently**. Additionally, a child-friendly area in the basement allows users to leave their children under supervision when needed, ensuring peace of mind while they work.

## Exterior Wall Surfaces for Mural Installations

### BC EM 01 - Exterior Mural



This is a mural located in the ceiling of one of the arrival points of the business Center, it should spark curiosity.

**Size: Irregular**



Interior Wall Surfaces for Mural Installations

### **BC IM 01 - Interior Mural**

This mural should promote **sustainability and local craftsmanship**, provide **visual and tactile interest**, and celebrate Pan-Africanism and African culture.

**Size: Width 5.60 m | Height 2.15 m**

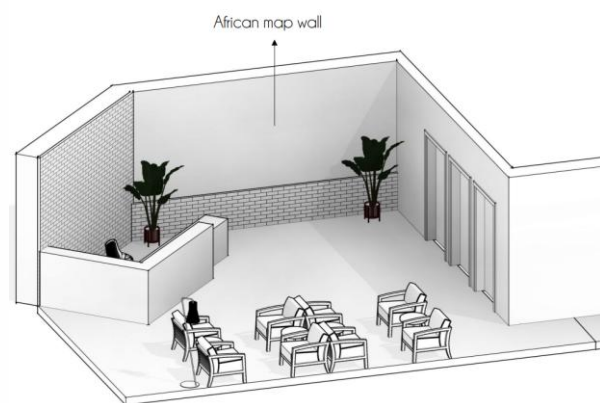

### **BC IM 02 - Interior Mural**

Colorful minimalist flowing mural with **success themed text** like "Think outside the box", and "Trust the process" included. The mural includes images (in circles) that drive in this texts and the idea of success from an African point of view

**Size: Width 22 m | Height 2.65 m**

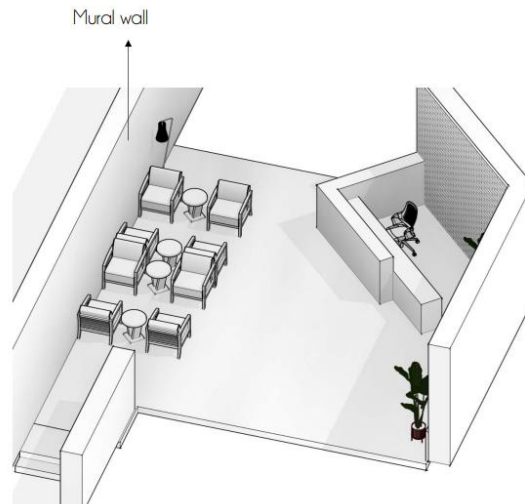

## Sculptures

### **BC SC 01 - Sculpture**

This sculpture is located in the entrance of the Business Center, it should be an installation that shows the progress and evolution of the Digital Ecosystem in Cabo Verde.



## Training Center Center

The ground floor of the Training Center houses a **vibrant** library that offers coworking spaces available for a daily fee. This space is designed to be exciting and valuable, making it an **appealing choice** for those seeking a dynamic environment to work from.

On the upper floor, multiple nooks are tucked away between the training rooms, intentionally hidden to **spark curiosity and encourage exploration**. Each nook offers a unique setup for working and collaboration, providing diverse and inspiring spaces that invite **discovery and creativity**.

### Exterior Wall Surfaces for Mural Installations

#### TC EM 01 - Exterior Mural

This is a mural located in the ceiling of the exterior hall that connects 3 buildings, it should spark curiosity and showcase movement.

**Size: Irregular**

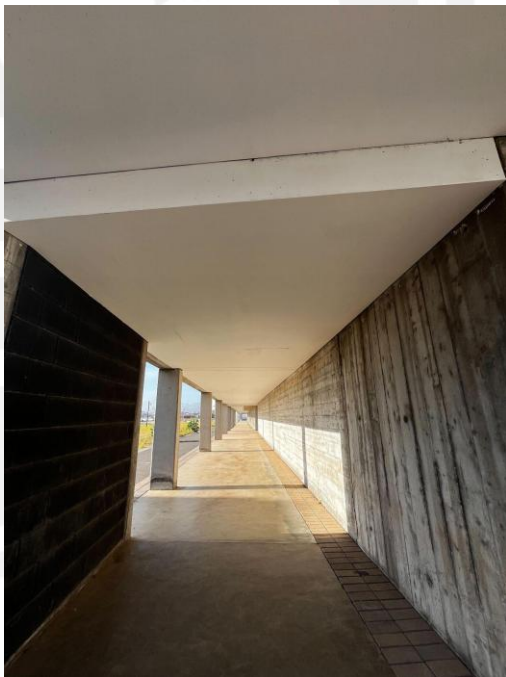



## Sculptures

### TC SC 01 - Sculpture

This sculpture is located in the Center of the training center spiral shape. It should be an installation that creates a fun seating area in the exterior, where people can enjoy the great weather of Cabo Verde and connect in between the training classes.



### Conference Center

The Conference Center serves as the civic **heart of the park**, welcoming the public and deeply **reflecting the local culture**. This space invites visitors to learn more about the rich history of the surrounding neighborhood, from its roots as a **fishing village to being home to one of the largest Tabanka celebrations**. The building will host exhibitions, making it a **must-visit destination in the city**—whether to view the showcased art, enjoy a coffee, or attend an event

## Exterior Installations

## CC EI 01 - Exterior Installation

This installation aims to bring **color and shade** to the central patio in the Conference Center. Here we envision smaller scales of vibrant and circular **reflective canopies** being placed. The striking effect of the canopy **draws attention from afar, enticing visitors to step in and explore**. The circular design of the space is **inspired by the "Tabanka" culture**, where locals form a circle to dance to the music, **symbolizing unity and celebration**.

### Interior Wall Surfaces for Mural Installations

## CC IM 01 - Interior Murals

This mural is inspired by Cape Verde's **rich maritime heritage**, reflecting the island's deep **connection to the sea, its waves, and its fishing culture**. Every design element in the lounge evokes the natural beauty and spirit of Cape Verde, creating a space that feels both **culturally authentic and visually immersive**. The color palette draws directly from the deep blues of the ocean, with tones that **mimic the movement of the sea and the calmness of the waves**.

**Size: Width 12 m | Height 2 m**



## CC IM 02 - Interior Murals

A wall hung Installation Art sculpture, that **celebrates the cultural heritage** as well as the occupation of the Cape Verdean people. The Mural should include **inspiration in the "TABANKA" festival scene and fishing village elements** like fishing boats and tools, showcasing the local trade of the people and also making this a part of the celebration.

**Multiple mediums** should be explored including **recycled materials**, and the art installation should also have depth.

**Size: Width 6 m | Height 18 m**



### **CC SC 01 - Sculpture**

This sculpture is located in the entrance of the Conference Center, it should be an installation that **welcomes visitors**. It should symbolize this **international openness**, while embodying the park's **spirit of hospitality and global collaboration**. This artwork would **highlight** the park's **commitment to diversity, inclusivity, and innovation on a global scale**.





## Skate Park

### SP EM 01 - Exterior Mural

The TechPark CV has a skate park where the intent is to produce a mural to bring energy and color to the area. The mural should inspire **movement, wellbeing and innovation**.

**Size: Irregular.**

